

SELECTIVE CLEARING AND GRUBBING - GENERAL NOTES

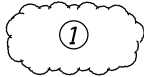

DESIGNATES AREAS TO REMAIN NATURAL. NO CLEARING OR GRUBBING IN THESE AREAS. NO EQUIPMENT SHALL ENTER THESE AREAS. NO STAGING, STORAGE OR DUMPING IN THIS AREA.



DESIGNATES AREAS WHERE TREES AND STUMPS OVER 3" IN DIAMETER SHALL BE CUT FLUSH WITH THE GROUND OR REMOVED, AND ALL UNDERGROWTH IS TO REMAIN NATURAL. NO EQUIPMENT SHALL ENTER THESE AREAS THAT WOULD IN ANY WAY DAMAGE THE PLANT MATERIAL TO REMAIN. NO STAGING, STORAGE, OR DUMPING IN THIS AREA.



DESIGNATES AREAS WHERE TREES OF 3" IN DIAMETER OR GREATER ARE TO REMAIN AND ALL UNDERGROWTH IS TO BE REMOVED. ONLY RUBBER TIRE EQUIPMENT SHALL ENTER THESE AREAS, AND REMAINING TREES SHALL BE PROTECTED FROM ROOT AND TRUNK DAMAGE. NO STAGING, STORAGE, OR DUMPING IN THIS AREA.



DESIGNATES AREAS WHERE THE TYPE AND EXTENT OF CLEARING AND GRUBBING SHALL BE DETERMINED BY THE ENGINEER ACCORDING TO FIELD CONDITIONS.

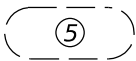

DESIGNATES AREAS THAT SHALL REMAIN NATURAL WHEN, IN THE OPINION OF THE ENGINEER, ADEQUATE AND DESIRABLE NATURAL VEGETATION OR GRASS EXIST. WHERE THIS TYPE VEGETATION DOES NOT EXIST, ONLY HARROWING, DISKING, LEVELING, AND/OR CLEAN-UP SHALL BE UNDERTAKEN, TO A DEGREE SUFFICIENT TO PREPARE THE AREA FOR GRASSING OPERATIONS.

AREAS WHERE EQUIPMENT IS NOT ALLOWED AND OTHER LOCATIONS, AS DIRECTED BY THE ENGINEER, THAT MUST BE PROTECTED BY TREE GUARDS. THE LOCATION FOR TREE GUARDS SHALL BE SHOWN IN THE PLANS.

ALL OTHER AREAS NOT INCLUDED IN ONE OF THE ABOVE CATEGORIES, OR THOSE DESIGNATED BY THE TYPICAL SECTIONS, SHALL BE STANDARD CLEARING AND GRUBBING.

WHERE UNFORESEEN SITE CONDITIONS EXIST, ADJUSTMENTS OR EXCEPTIONS MAY BE MADE TO THE ABOVE PROCEDURE AT THE DIRECTION OF THE ENGINEER.

FINISH SOIL LAYER - GENERAL NOTES

STOCKPILING OF FINISH SOIL LAYER MATERIAL IS TO BE DONE ONLY IN AREAS REQUIRING STANDARD CLEARING AND GRUBBING AND/OR AREAS DESIGNATED AS TYPE 5 (SEE SELECTIVE CLEARING AND GRUBBING - GENERAL NOTES).

TYPE 4 AREAS MAY BE USED FOR STOCKPILING OF FINISH SOIL LAYER MATERIAL ONLY WHERE SUCH AREAS HAVE BEEN CLEARED, AT THE DIRECTION OF THE ENGINEER DURING CONSTRUCTION OPERATIONS.

SUFFICIENT AREA HAS BEEN DESIGNATED SO THAT ALL STOCKPILING MAY BE DONE IN ACCORDANCE WITH THE REQUIREMENTS LISTED ABOVE.

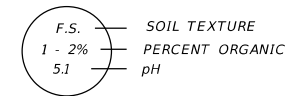

SOIL INFORMATION DETAIL

EXPLANATION OF SYMBOLS & SOIL TEXTURE ABBREVIATIONS

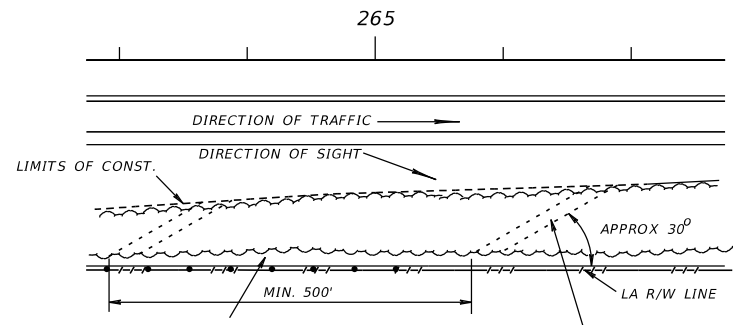

10' STRIP WHICH MAY BE CLEARED FOR FENCE CONSTRUCTION WITH SELECTED DESIRABLE TREES ALLOWED TO REMAIN, AS DIRECTED BY THE ENGINEER.

AT THE DIRECTION OF THE ENGINEER, DIAGONAL PATH MAY BE CUT IN AREAS TO REMAIN NATURAL, AS SHOWN ABOVE, FOR THE REMOVAL OF TIMBER AND STUMPS FROM THE AREA CLEARED FOR FENCE CONSTRUCTION.

ACCESS FOR FENCE CONSTRUCTION

(APPLIES TO ALL TYPES OF SELECTIVE CLEARING AND GRUBBING)

EXHIBIT SCG-1
Date: 1/1/12

REVISIONS				STATE OF FLORIDA DEPARTMENT OF TRANSPORTATION			SELECTIVE CLEARING AND GRUBBING	SHEET NO.
DATE	DESCRIPTION	DATE	DESCRIPTION	ROAD NO.	COUNTY	FINANCIAL PROJECT ID		
				10	LEON	123456-1-52-01		

r0960jr

1/19/2012

2:03:13 PM

5FILES

NOTICE: THE OFFICIAL RECORD OF THIS SHEET IS THE ELECTRONIC FILE SIGNED AND SEALED UNDER RULE 61G15-23.003, F.A.C.

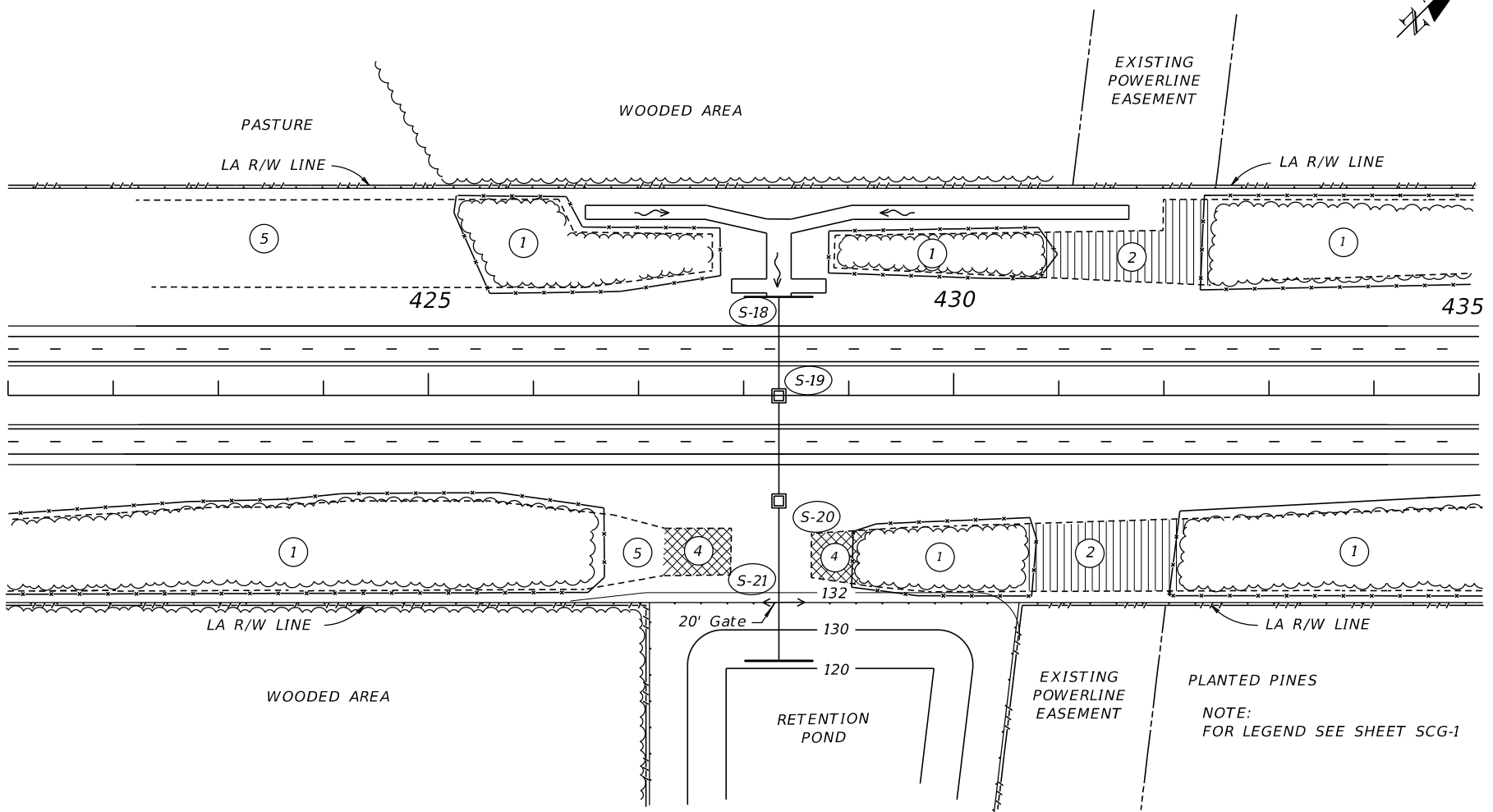
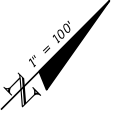

EXHIBIT SCG-2
Date: 1/1/12

REVISIONS				STATE OF FLORIDA DEPARTMENT OF TRANSPORTATION	SELECTIVE CLEARING AND GRUBBING			SHEET NO.
DATE	DESCRIPTION	DATE	DESCRIPTION					
				10	LEON	123456-1-52-01		

NOTICE: THE OFFICIAL RECORD OF THIS SHEET IS THE ELECTRONIC FILE SIGNED AND SEALED UNDER RULE 61G15-23.003, F.A.C.