

One-Way Traffic

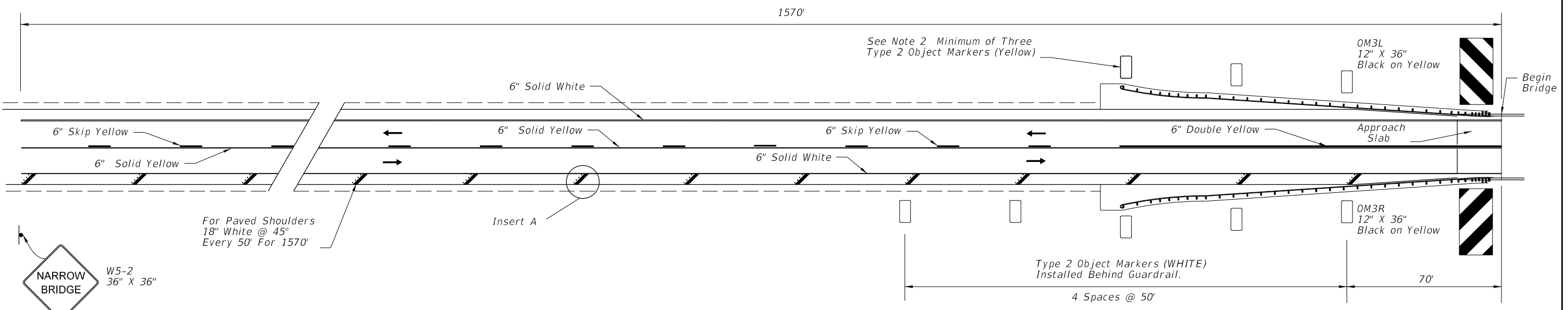

2-Way Traffic

11/30/2015 2:20:19 PM

LAST REVISION 07/01/13	REVISION	DESCRIPTION:	 FY 2016-17 DESIGN STANDARDS	RURAL NARROW BRIDGE TREATMENT	INDEX NO. 17359	SHEET NO. 1 of 2
---------------------------	----------	--------------	---	-------------------------------	--------------------	---------------------

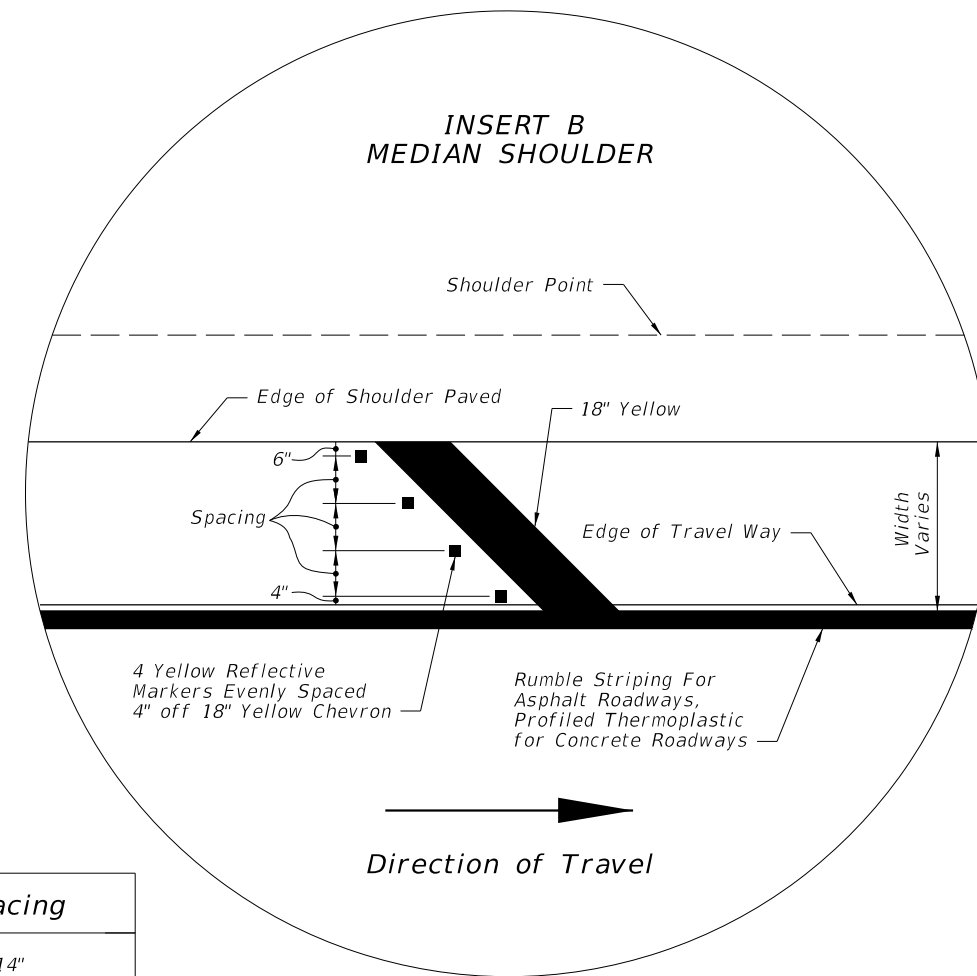
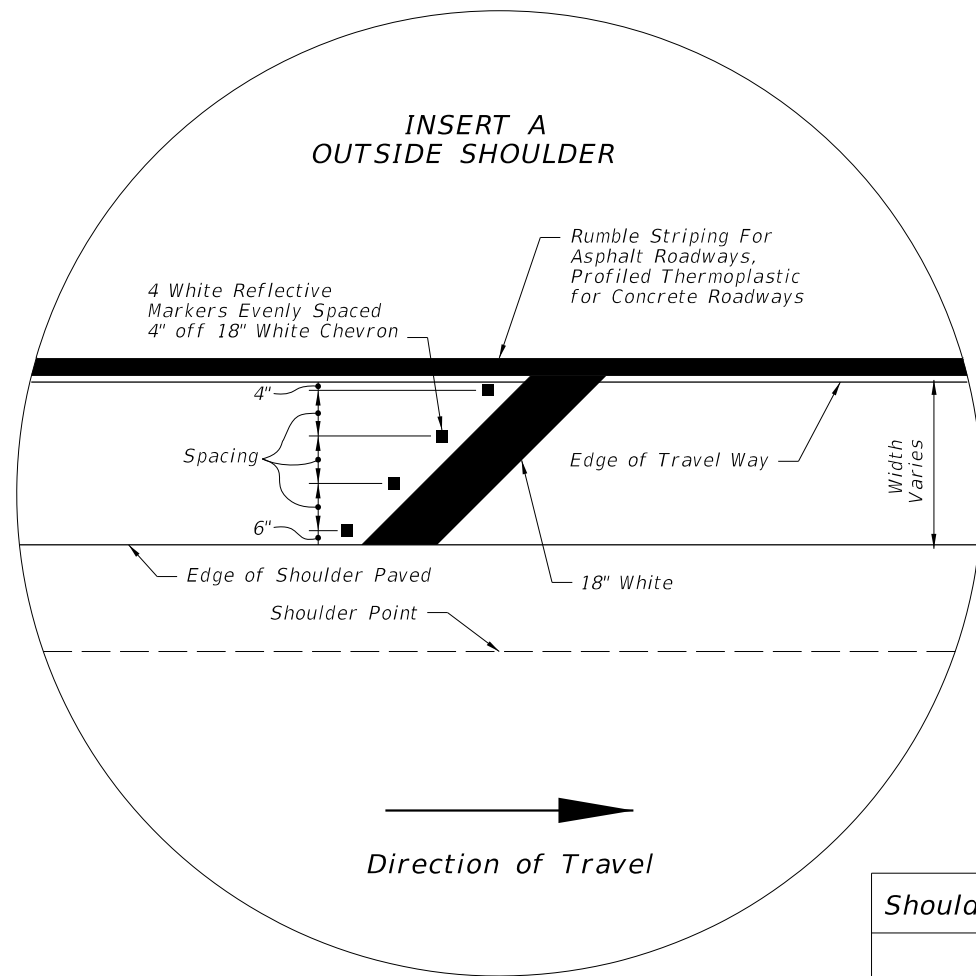

Shoulder Width	No. of RPM's	Spacing
2'	2	14"
3'	3	13"
4'	3	19"
5'	4	16.67"

NOTES:

- Roadways with Two-Way Traffic:
No passing zone should be extended 1570' in advance of narrow bridge.
- If the bridge or the approach is on a curve, delineators shall be installed for a distance of 1570' in advance of narrow bridge on the outside portion of the roadway. Spacing shall be 100' between delineators. Delineators are to be placed not less than 2' or not more than 8' outside the outer edge of pavement.
- Object markers and delineators on both sides of roadway shall face traffic approaching bridge
- The OM-3R & OM-3L object markers shall be installed 4' above the roadway edge. The panels may be post mounted at the bridges.

11/30/2015 2:20:19 PM