

C:\projects\standards\roadway\17300-s\17347-01.dgn
sm970re
7:16:00 PM
6/24/2013

1. Recommended placement of bicycle lane markings:
 - a) At the beginning of a bicycle lane, on the far side of major intersections, and prior to and within the bicycle lane keyhole.
 - b) Along the roadway as needed to provide a maximum spacing of 1,320 feet for posted speeds less than 45 mph, 2,640 feet for a posted speed of 45 mph or greater.
2. Recommended spacing for shared lane marking symbols: Immediately after intersections and at a maximum spacing of 250 feet.
3. All pavement markings and pavement messages shall be White.
4. All pavement messages shall be performed thermoplastic.
5. Bike lane signs (R3-17, R3-17a, R3-17b) are not required.

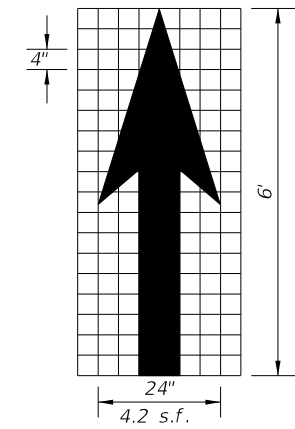
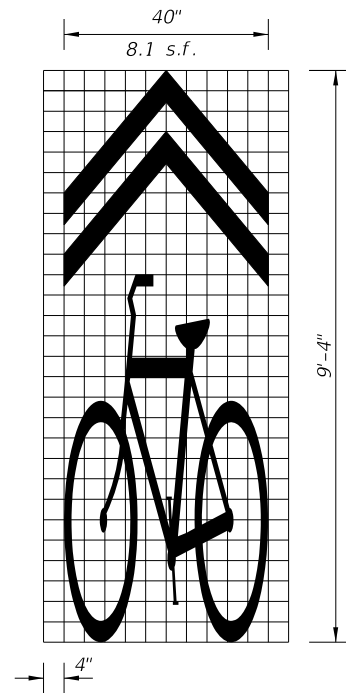
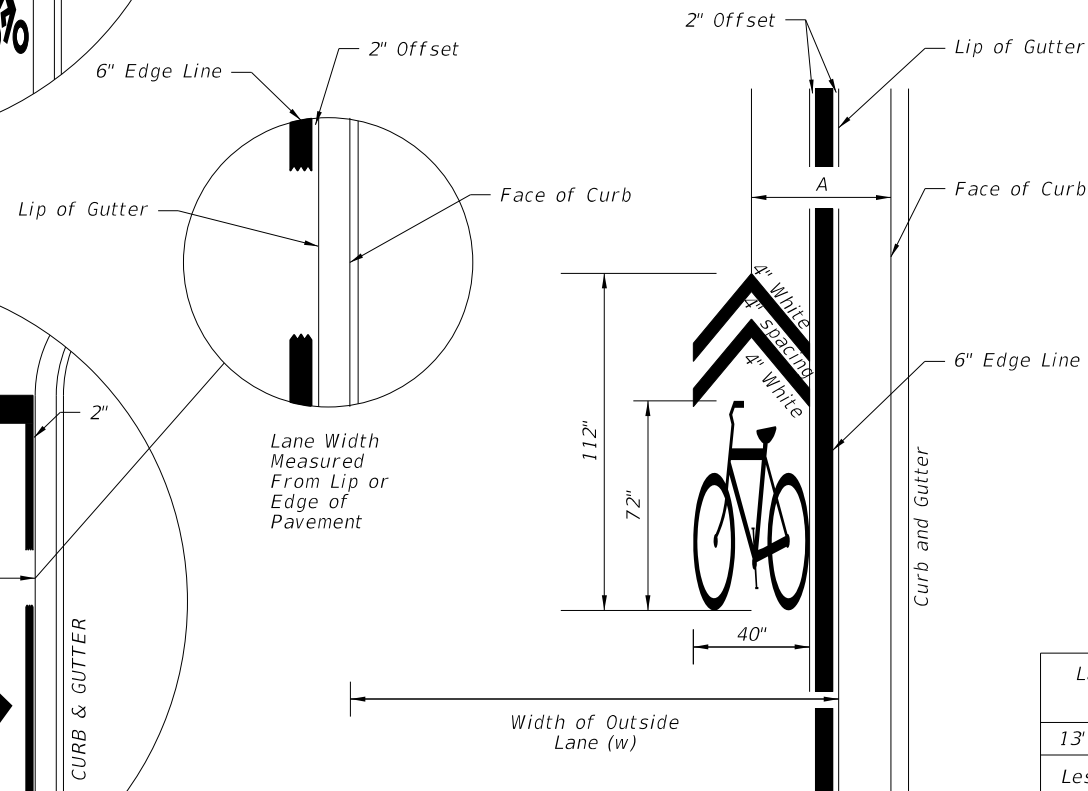
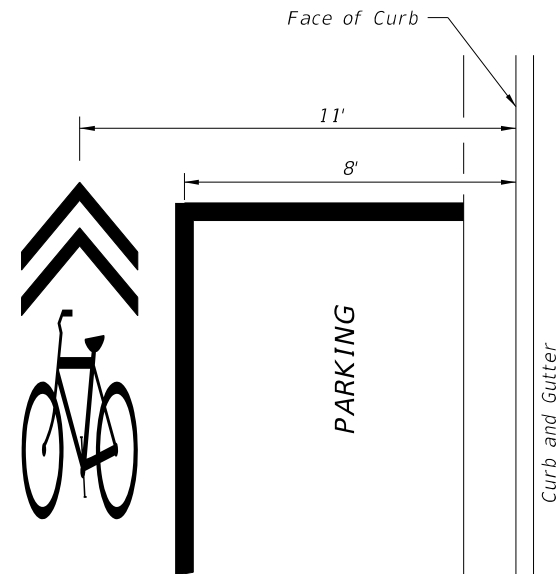
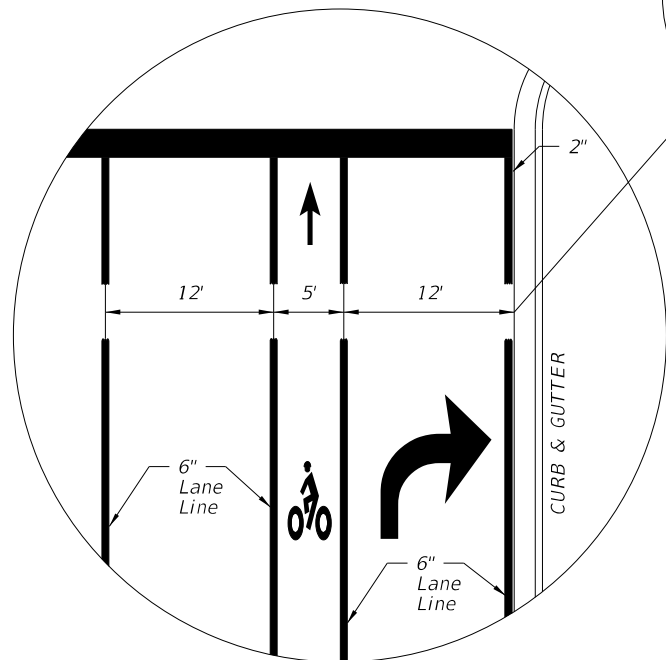
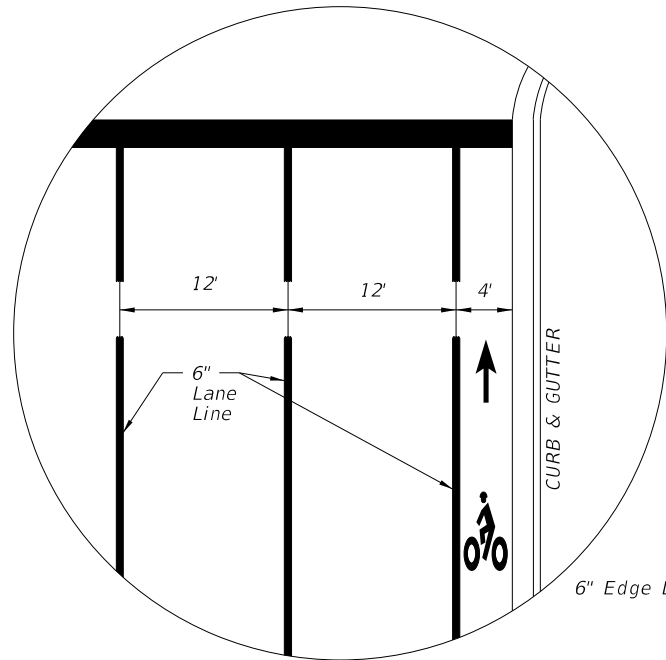

No stripe at edge of curb & gutter or paved shoulders.

6" WHITE

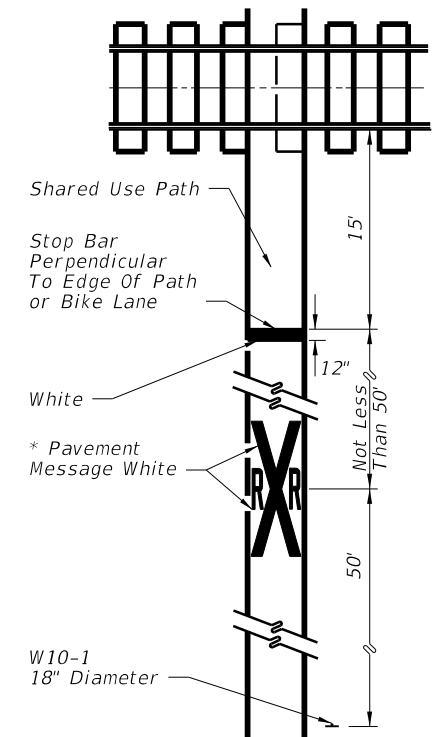
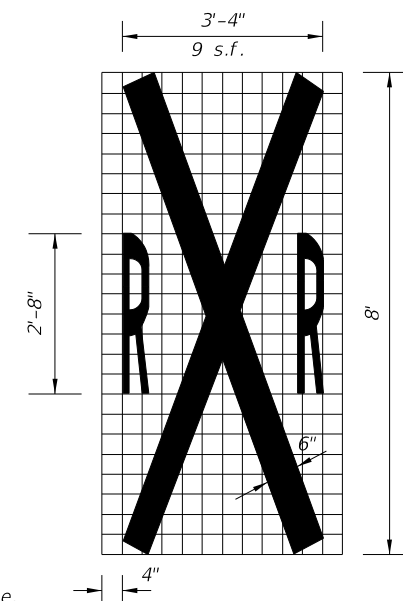
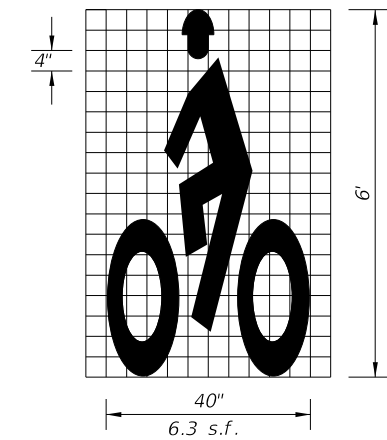

* When used in bike lane, markings shall be placed adjacent to markings in travel lane and W10-1 sign shall be deleted.

LAST REVISION	DESCRIPTION:
07/01/12	

INDEX NO.	SHEET NO.
17347	1 of 4

6/24/2013 7:16:02 PM sm970re C:\projects\standards\roadway\17300-s\17347-02.dgn

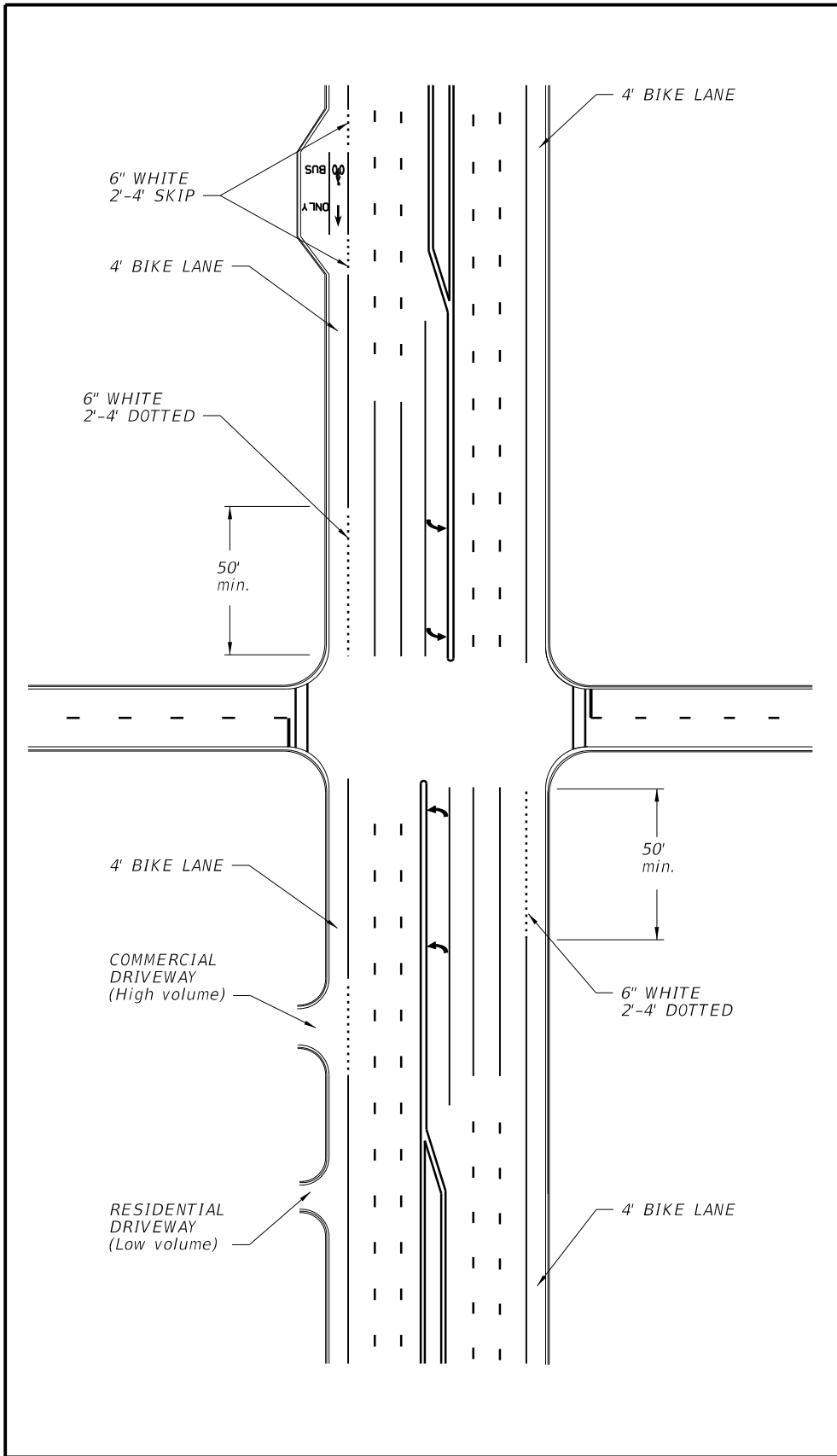

INTERSECTION WITH BUS BAY,
NO RIGHT TURN LANE, CURB
AND GUTTER TYPICAL SECTION

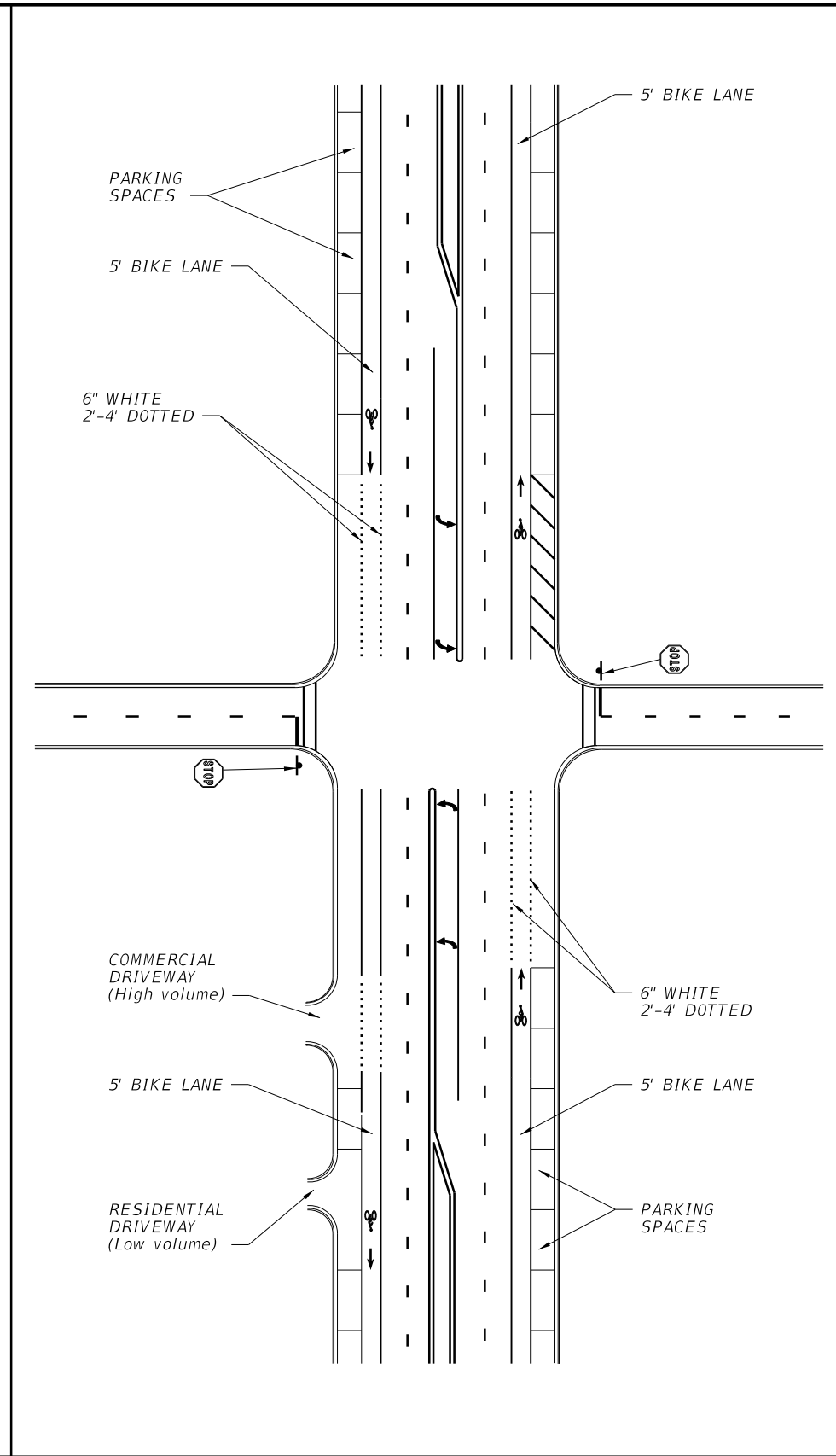

INTERSECTION WITH ON STREET
PARKING, NO RIGHT TURN LANE,
CURB AND GUTTER TYPICAL SECTION

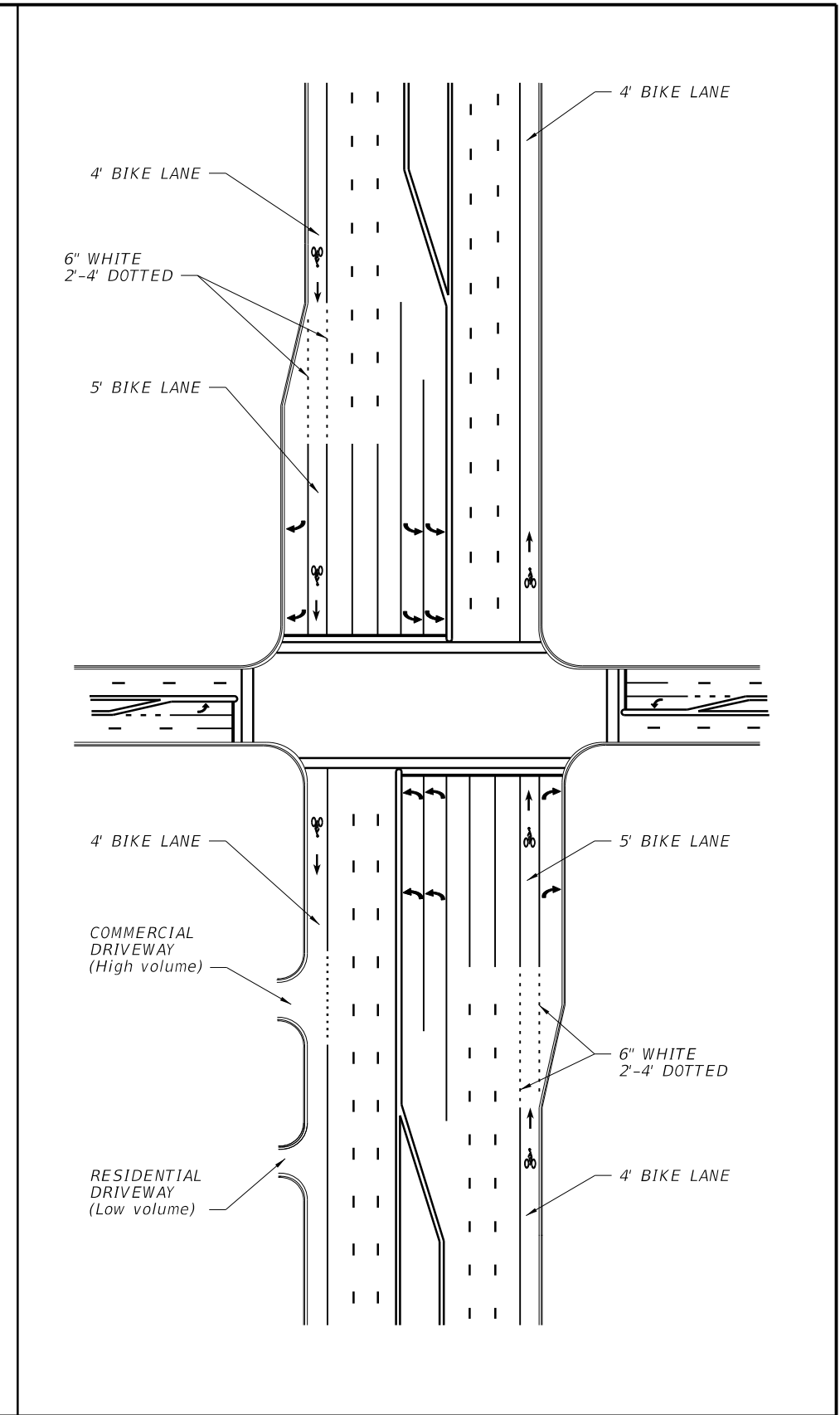

INTERSECTION WITH SEPARATE
RIGHT TURN LANE, CURB AND
GUTTER TYPICAL SECTION

LAST REVISION 07/01/12	REVISION	DESCRIPTION:	 FDOT 2014 DESIGN STANDARDS	BICYCLE MARKINGS	INDEX NO. 17347	SHEET NO. 2 of 4
------------------------------	----------	--------------	--	-------------------------	------------------------------	-------------------------------

6/24/2013 7:16:03 PM sm970re C:\projects\standards\roadway\17300-s\17347-03.dgn

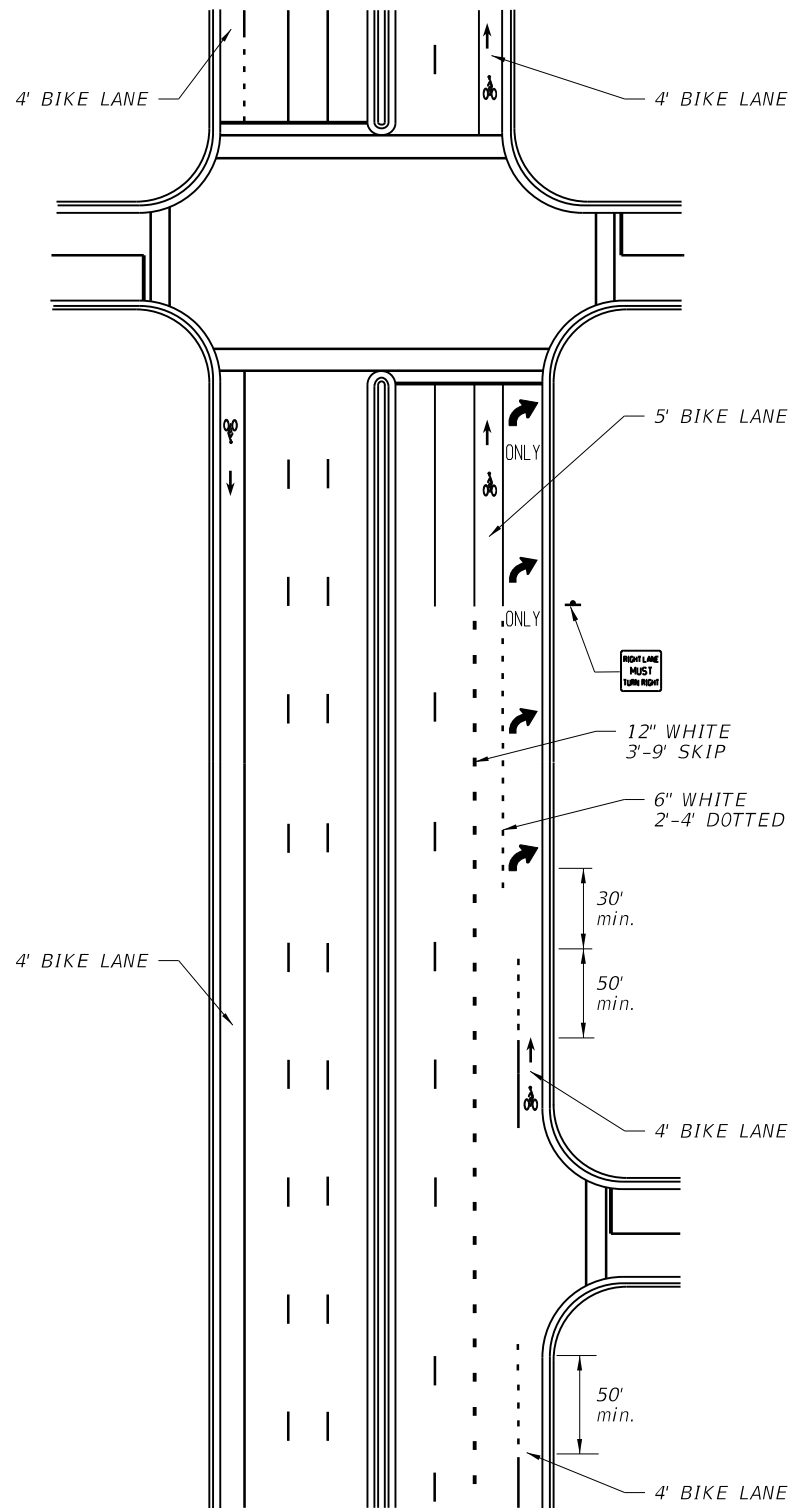

INTERSECTION WITH RIGHT TURN DROP LANE, CURB AND GUTTER TYPICAL SECTION

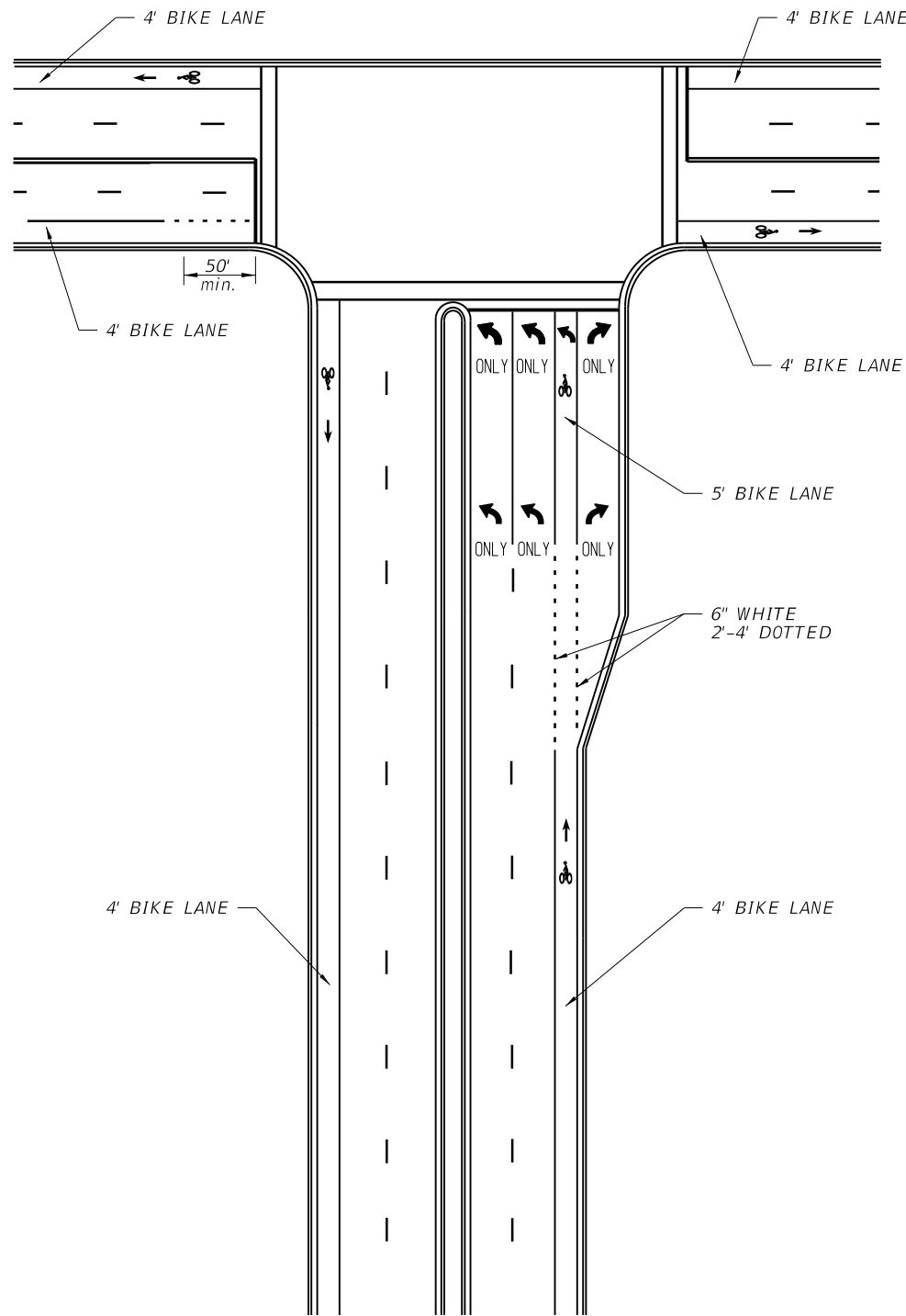

"TEE" INTERSECTION WITH SEPARATE RIGHT TURN LANE, CURB & GUTTER TYPICAL SECTION

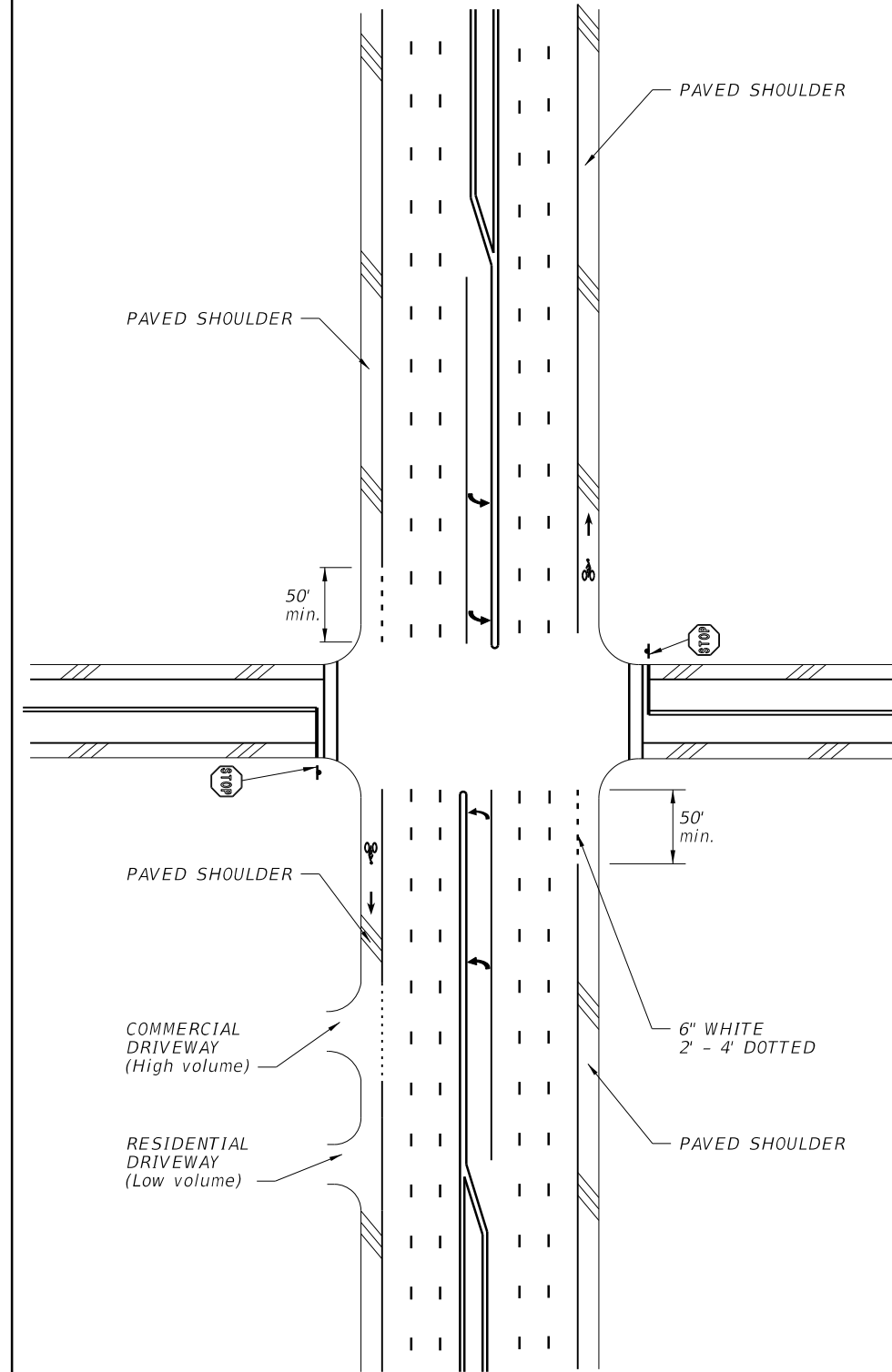

INTERSECTION, NO RIGHT TURN LANE, FLUSH SHOULDER TYPICAL SECTION

LAST REVISION
07/01/12

DESCRIPTION:



FDOT 2014
DESIGN STANDARDS

BICYCLE MARKINGS

INDEX NO.
17347

SHEET NO.
3 of 4

C:\projects\standards\roadway\17300-s\17347-04.dgn
sm970re
7:16:05 PM
6/24/2013

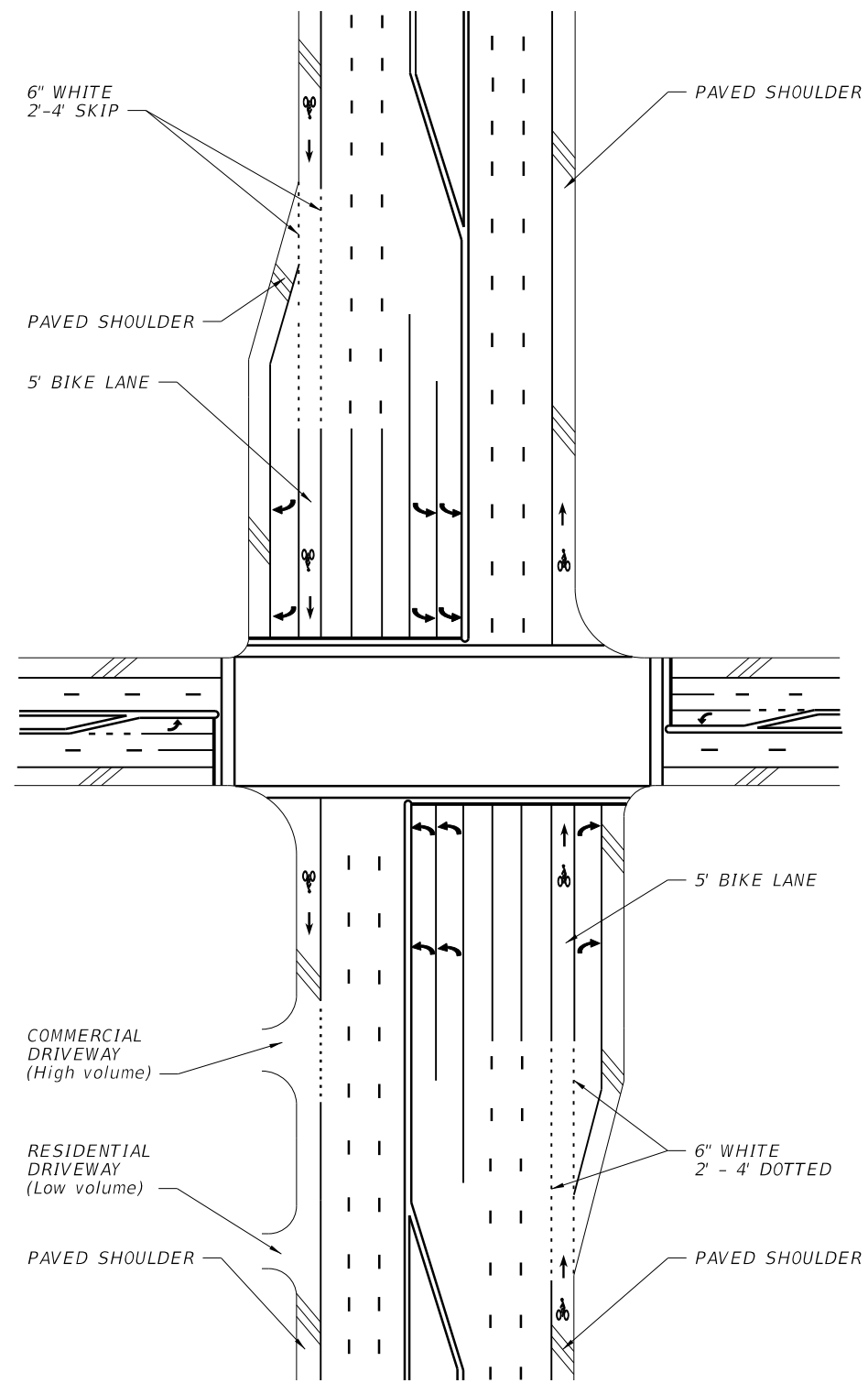

INTERSECTION WITH SEPARATE RIGHT TURN LANE, FLUSH SHOULDER TYPICAL SECTION

LAST REVISION
07/01/13

REVISION DESCRIPTION:

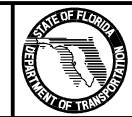

FDOT 2014
DESIGN STANDARDS

BICYCLE MARKINGS

INDEX NO.
17347

SHEET NO.
4 of 4