

ELEVATION
FENCING TERMINALS AT BRIDGE ENDS (ROADWAY)

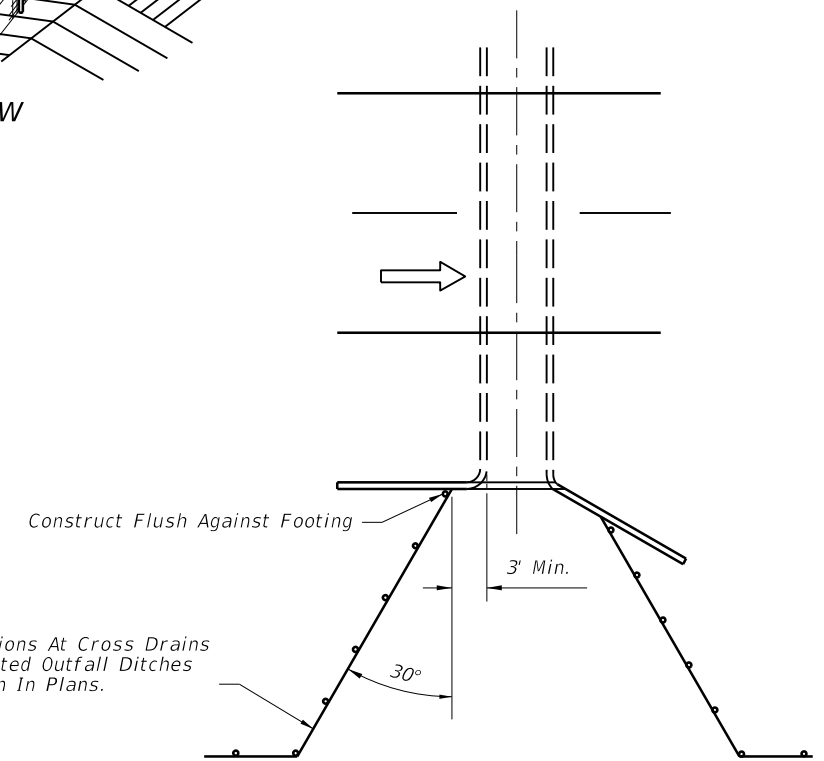

PLAN
 (For Heights Of Headwall Greater Than 4')
FENCING TERMINALS AT BOX CULVERTS

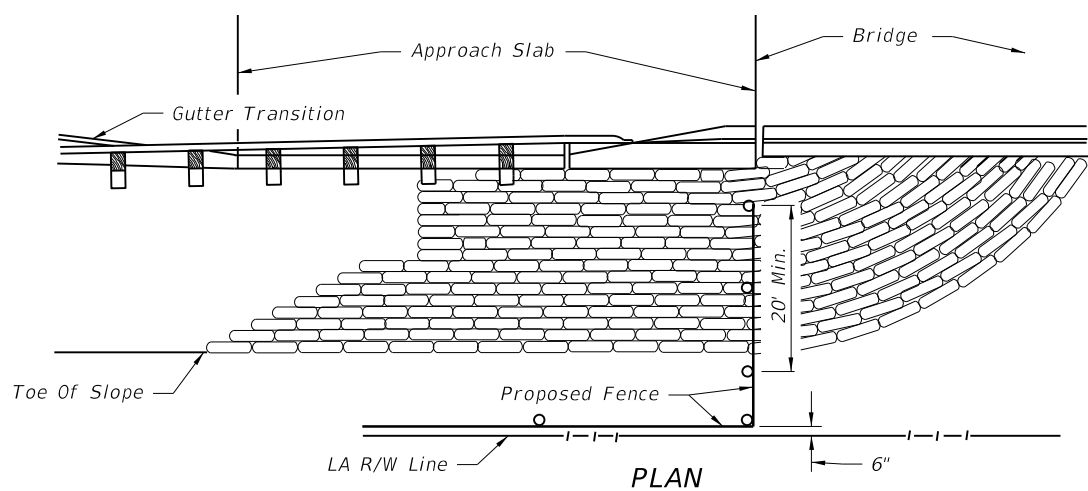

FENCING TERMINALS AT BRIDGE ENDS (STREAM CROSSING)

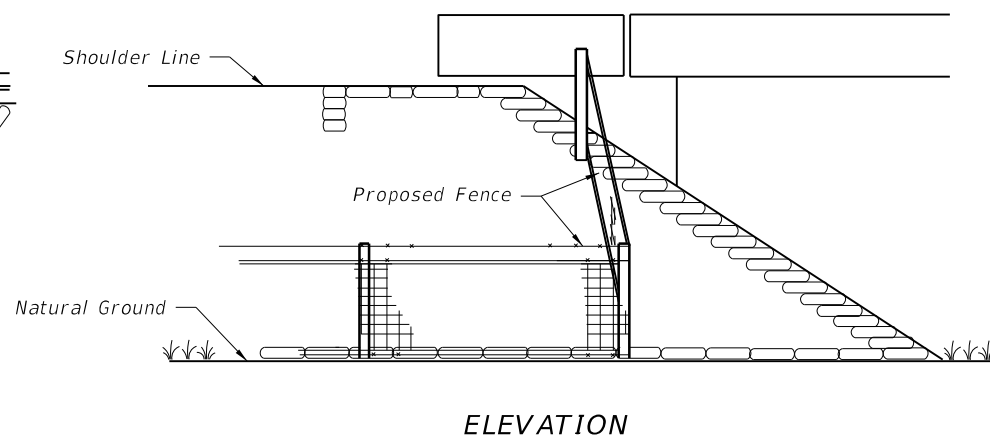

ELEVATION

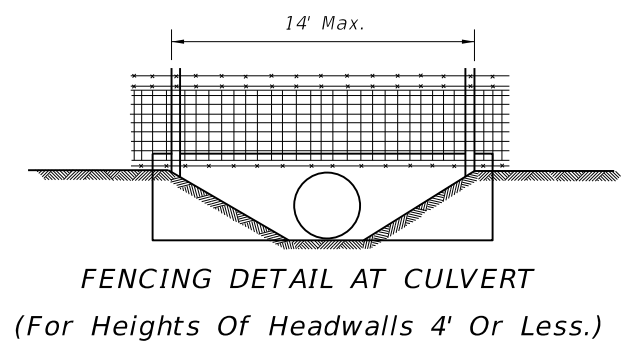

FENCING DETAIL AT CULVERT (For Heights Of Headwalls 4' Or Less.)

Note: When height of headwall is 4' or less (drainage pipe 36" or less) the fence shall not be tied to the headwall, but shall span the lateral ditch.

C:\projects\standards\roadway\0800-s\0800-01.dgn 6/29/2012 11:03:50 AM rd960rh

LAST REVISION 07/01/05	DESCRIPTION:	 FDOT DESIGN STANDARDS 2013	FENCE LOCATION	INDEX NO. 800	SHEET NO. 1

C:\projects\standards\roadway\0800-s\0800-02.dgn
 rd960rh
 11:03:52 AM
 6/29/2012

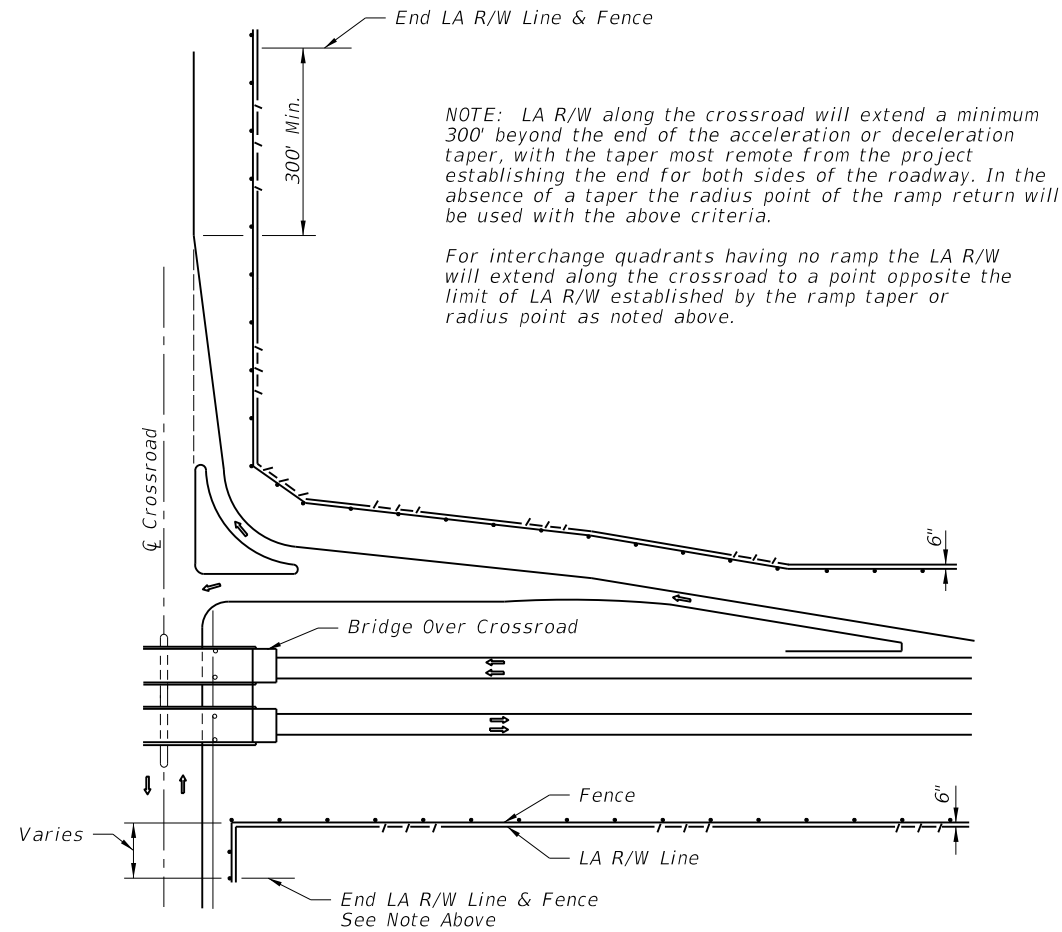

APPLIES TO BRIDGE OVER CROSSROAD AND CROSSROAD OVER FREEWAY (BRIDGE OVER CROSSROAD SHOWN)

FENCING TERMINALS AT RURAL INTERCHANGES

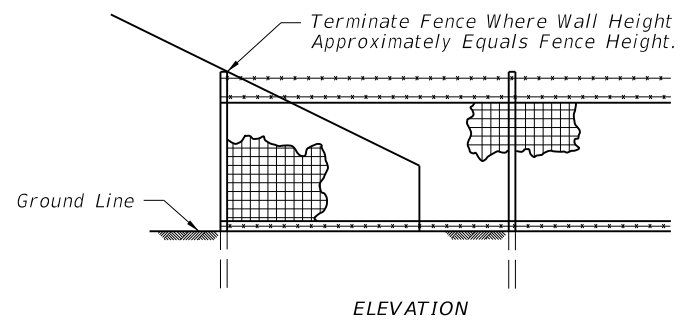
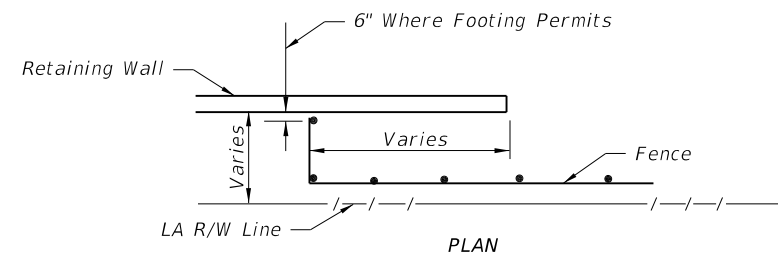

FENCING TERMINALS AT RETAINING WALLS

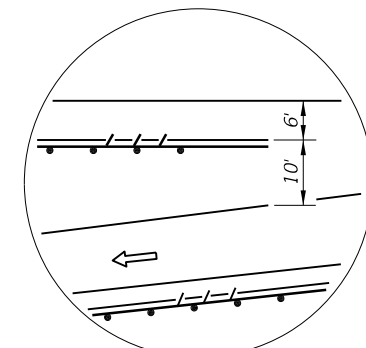

INSET A

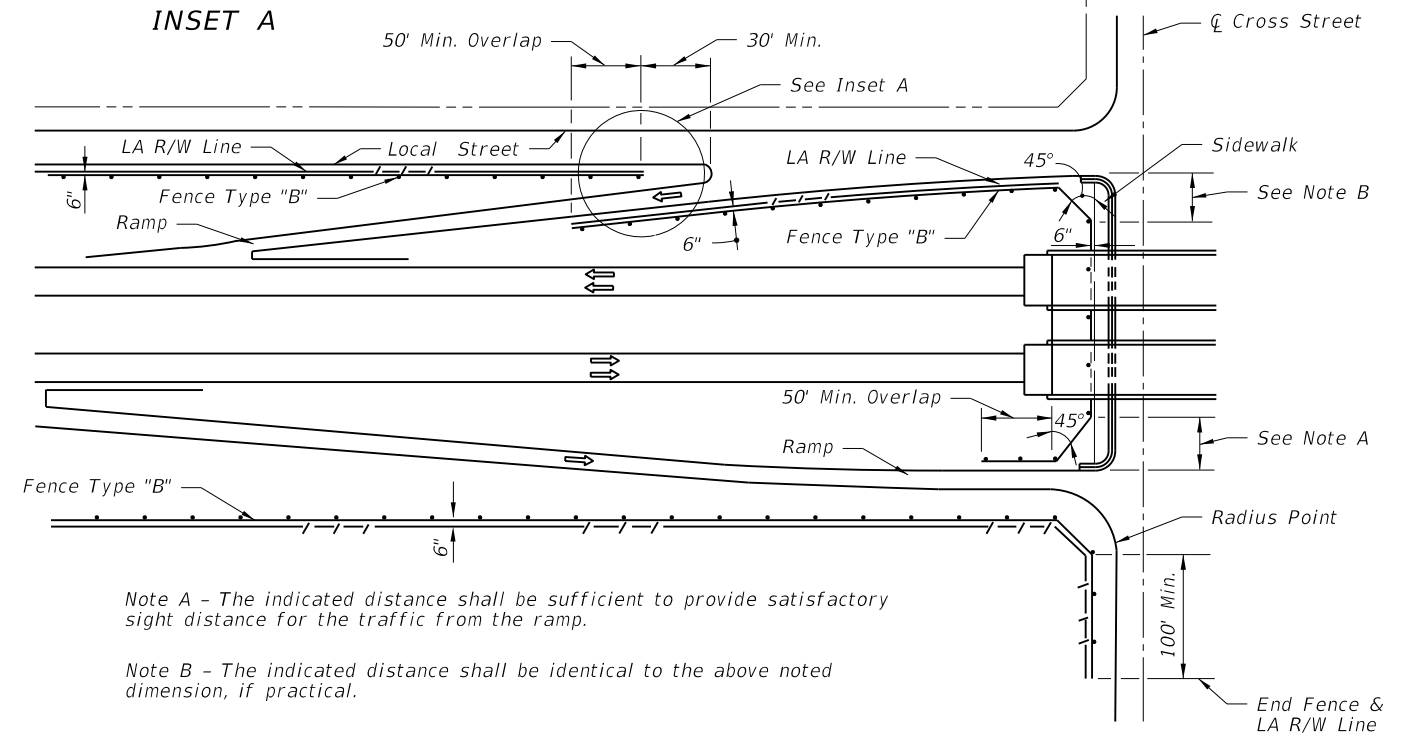

Note A - The indicated distance shall be sufficient to provide satisfactory sight distance for the traffic from the ramp.

Note B - The indicated distance shall be identical to the above noted dimension, if practical.

FENCING TERMINALS AT URBAN INTERCHANGES

LAST REVISION	REVISION	DESCRIPTION:		FDOT DESIGN STANDARDS 2013	FENCE LOCATION	INDEX NO.	SHEET NO.
07/01/05						800	2