

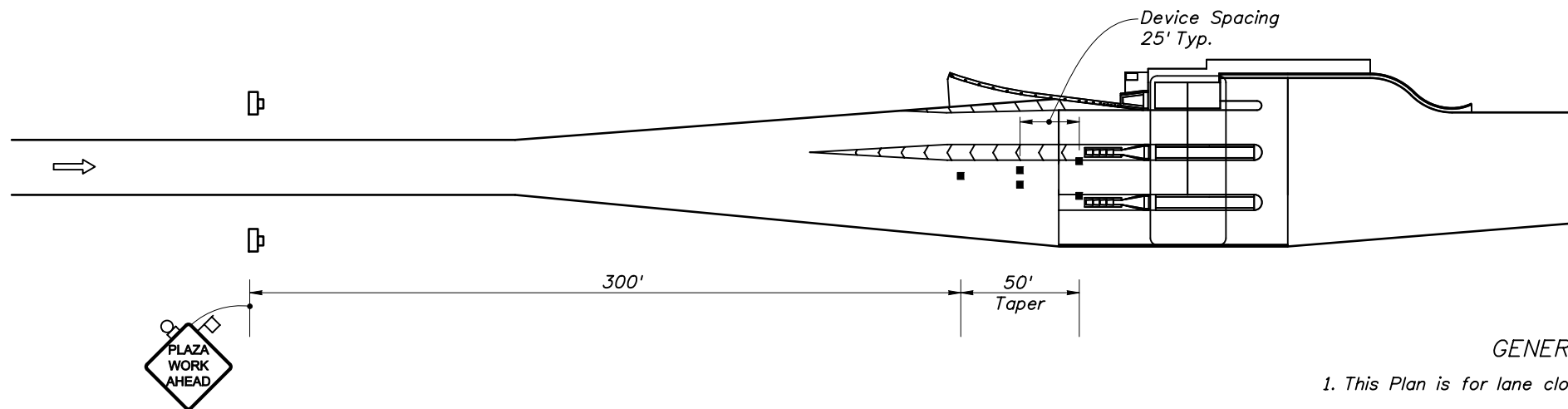





WORK DONE WITHIN TRAVEL LANE - ONE LANE CLOSED



WORK NOT DONE WITHIN TRAVEL LANE - ONE LANE CLOSED

SYMBOLS

-  Work Area
-  Sign With 18" x 18" (Min.) Orange Flag And Type B Light
-  Channelizing Device (See Index No. 600)
-  Work Zone Sign
-  Lane Identification + Direction of Traffic
-  Advance Warning Vehicle Equipped with Advance Warning Arrow Panel and Truck/Trailer Mounted Attenuator

GENERAL NOTES

1. This Plan is for lane closures that are three hours or less.
2. This Plan is to be used at Ramp or Mainline Plazas.
3. This plan can be used for any lane, with appropriate modifications, even if it is not in the center of the Plaza.
4. Lane use control lights, signs, or signals over toll lanes shall be switched to the appropriate symbol, message, or correct color prior to the start of any lane closure. They should also be switched at project completion.
5. At least 48 hours prior to any closure, other than emergencies, the plaza manager shall be notified for security and staffing.
6. A Truck/Trailer Mounted Attenuator is required for all aerial work operations (lift truck). For non-aerial operations, the Truck Mounted Attenuator or additional devices may be required by the Engineer based on the work being performed.

SHORT-TERM CLOSURES

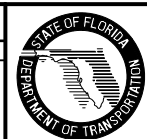
REVISIONS							2010 Interim Design Standard		Interim Date	Sheet No.
DATE	BY	DESCRIPTION	DATE	BY	DESCRIPTION		TOLL PLAZA TRAFFIC CONTROL STANDARDS		01/01/10	6 of 6
06/03/09	CA	Corrected 50' Taper and Channelizing Device number and spacing.				Index No. <b>667</b>				