

# Afternoon Peak Hour Traffic Operations

## 2016 Conditions

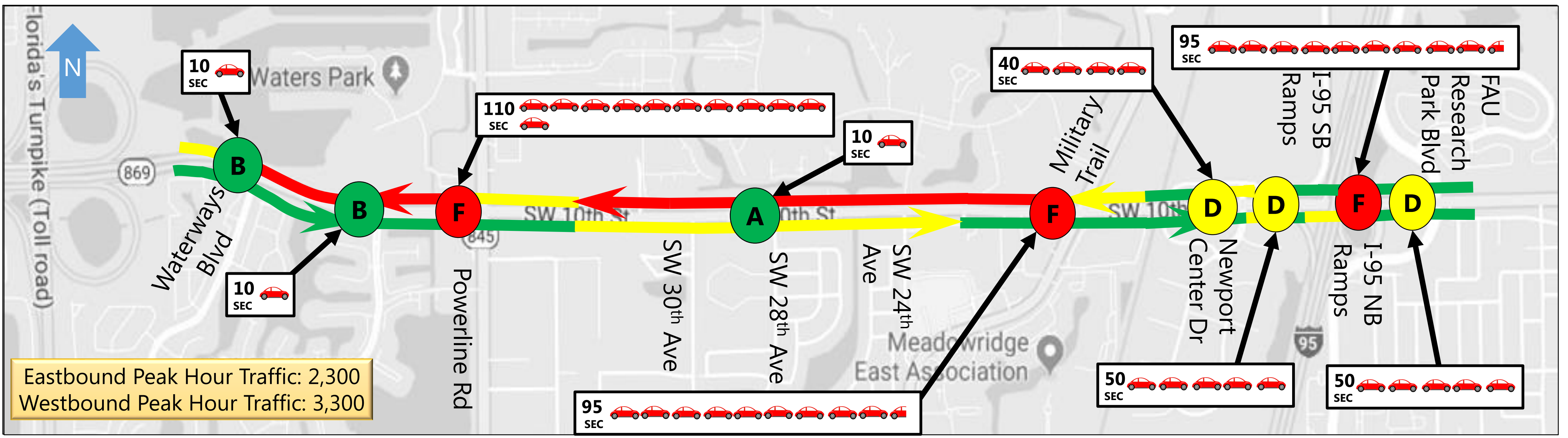

## 2040 No Build Conditions (No Interchanges and No SW 10th Street Improvements)

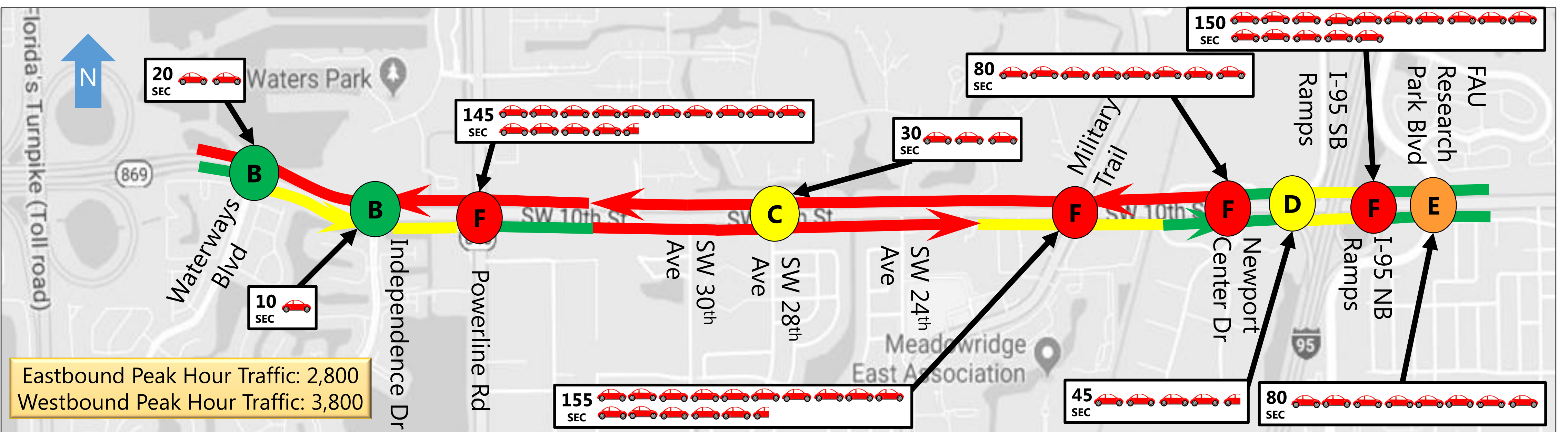

## 2040 with Interchange Improvements Only

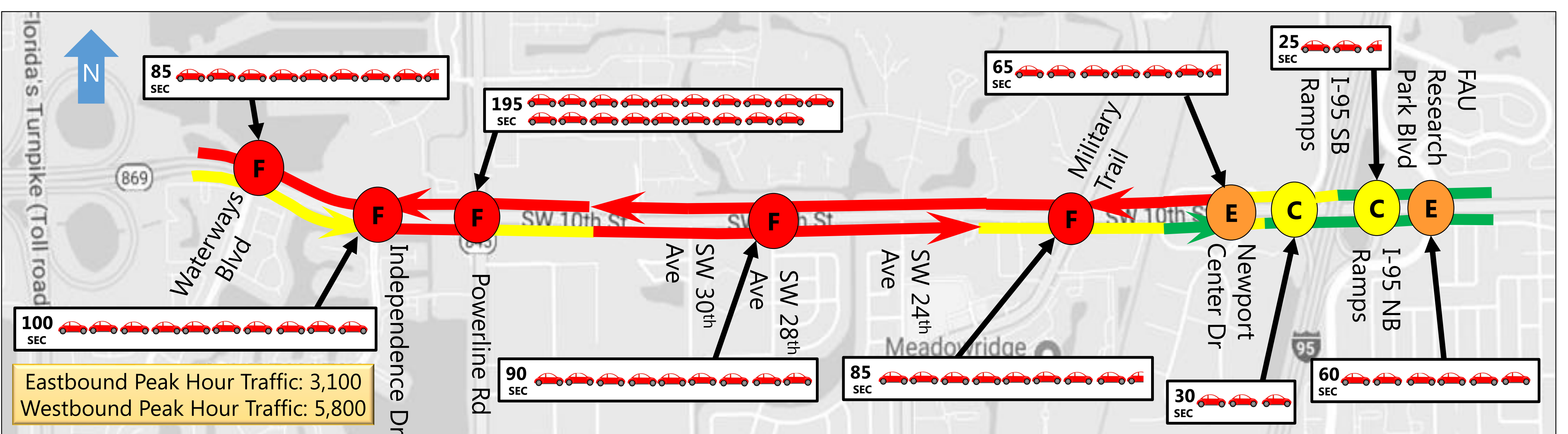

## 2040 with Interchanges and SW 10th Street Improvements

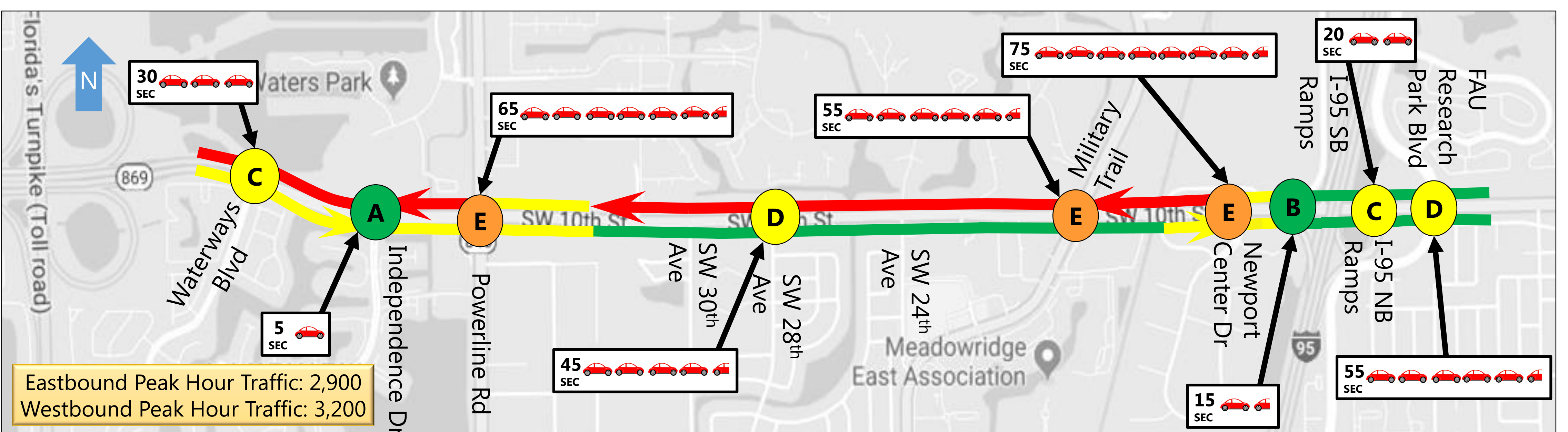

### LEGEND

#### Roadway Volume to Capacity (V/C) Ratio

(little to no delay, free flow speeds) V/C ≤ 0.74	Green line
V/C 0.75-0.99	Yellow line
V/C 1.00-1.99	Red line
V/C ≥ 2.00 (long delays, slow speeds)	Blue line

#### Signalized Intersection Level of Service

0-20 seconds of delay per vehicle	A B (15 SEC)
>20-55 seconds of delay per vehicle	C D (30 SEC)
>55 seconds of delay per vehicle	E F (85 SEC)